



## USER MANUAL

Clip English,  
DAB mini Radio



**IMPORTANT:** Please read the manual carefully before using the product and keep it for future reference.

**\*Manuals in other languages - please check [www.oxdigital.com](http://www.oxdigital.com)**

## Content

Unpacking	3
Button Instruction	4
OLED Display	6
Operation Language Setting	8
Changing Language While Using Clip	9
Clock Setting	10
Key Lock	11
Scan DAB radio stations	12
Auto scan:	12
Manual scan:	12
DAB Radio Operation	12
Listen to the DAB radio	13
Save your favourite list of the DAB radio stations	13
Play the favourite DAB -radiostation:	14
Exit the favourite mode	14
Pause or play the Clip Radio	15
Read Scrolling messages from DAB Station	15
Listen to FM radio	16
FM RADIO Operation	16
Scan FM radio station	16
Manual tuning	17
Pause or Play FM-radio	17
Power off timer	18
Deactivate Power Off Timer	19
Reset the DAB radio stations	19
Safety Information	20
Product specifications	20

## Unpacking

### Thank you for purchasing our product Clip Radio!

The pack should contain:

- 1 pc Clip radio
- 1 pc USB cable charger
- 1 pc User manual

Optional:

- 1 pc 3.5mm to 3.5mm line-in cable

**Note:** The original earphone is specially made for Clip-radio. We do not guarantee it works perfectly with other brands of earphones.

## Button Instruction



## Function overview

Controls, connectors and components	Functions
<b>ON / OFF</b>	Switch on and switch off. Play or pause DAB or FM radio
<b>DAB / FM / ↵</b>	(↵) As an enter button. To choose language mode To choose either DAB mode or FM mode. Save the favourite DAB radio station. Adjust FM frequency manually.
<b>Previous Button</b>	To select language Scan for the available DAB or FM radio stations. Choose the previous DAB or FM radio stations. Adjust FM frequency. Set the clock.
<b>Next Button</b>	To select language Scan for the available FM radio stations. Choose the next DAB or FM stations. Adjust FM frequency. Set the clock.
<b>Volume +</b>	To increase the volume level.
<b>Volume - / Lock</b>	To decrease the volume level, to lock and unlock the radio.

## OLED Display

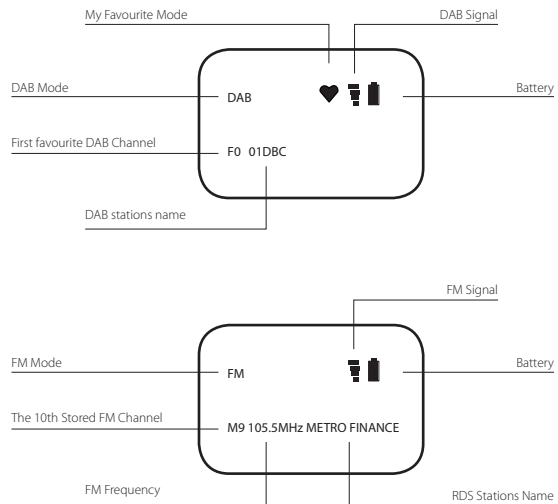

## OLED Display

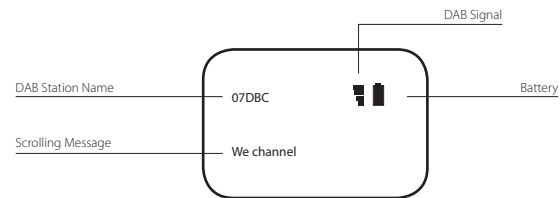

**NOTE:** Minor interference may occur while OLED is on, OLED will turn off automatically after a short while, resuming display by pushing any buttons.

## Operation Language Setting

### First Time Using or After Reset the Clip Radio

For the first time, user has to choose and set the operation language, OLED displays "Select Language" automatically, press DAB/FM to confirm, then press **◀** or **▶** for different languages (English, German, French, Italian, Norwegian, Danish, Swedish and Spanish), such as choosing "Deutsch" (German), then press "DAB/FM" to confirm. If no specific language has been chosen by user, DAB-Clip will set the default language as English automatically after 10 seconds.



## Operation Language Setting

### Changing Language While Using Clip

On the other hand, during idle situation (showing clock), press and hold DAB/FM to enter the "Select Language" menu, then press once again DAB/FM to confirm, and press **◀** or **▶** to choose different languages, press once again DAB/FM to confirm the chosen language. Wait for 10sec, the Clip will automatically return to standby mode. If accidentally entered the menu mode, simply press **◀** or **▶** and choose "Exit" to exit.

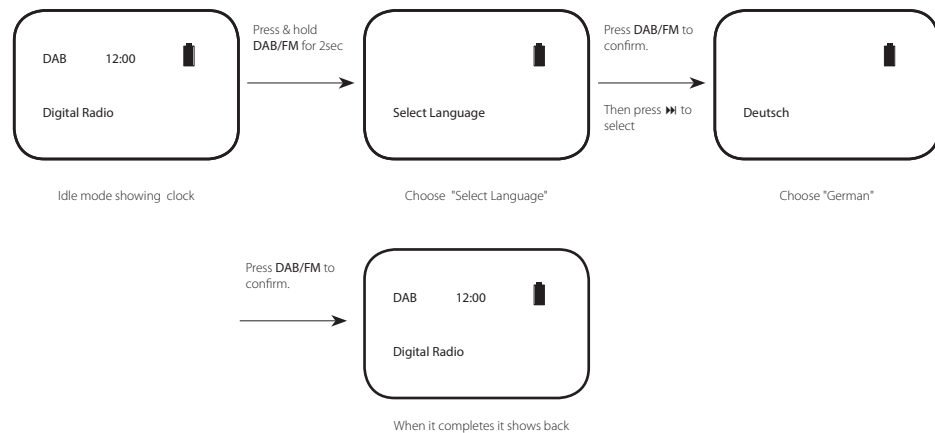

## Clock Setting

In DAB station mode, the clock is normally synchronized with the DAB stations. If the clock does not show the correct time, follow the instructions below to adjust it:  
In standby mode press and hold the DAB/FM for 2 seconds, and press **⏪** or **⏩** to choose "Set Time" for setting time, then press DAB/FM to confirm the time setting mode, OLED will display "Set Time" and hours will flash, press the **⏪** or **⏩** button to adjust the hour, confirming by pressing DAB/FM once again. And then it will show "Set Time" and minutes will flash, press the **⏪** or **⏩** button to adjust the minute, confirming and finishing by pressing DAB/FM again. Wait for 10 seconds and the Clip will return to standby again.

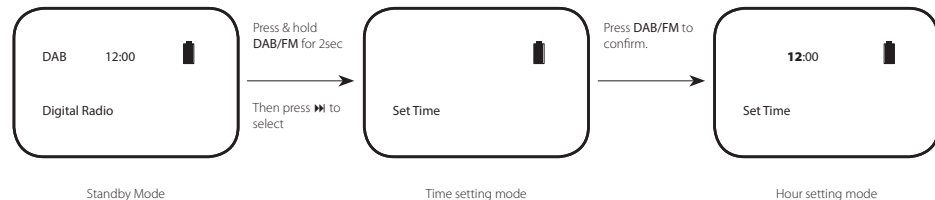

Standby Mode

Time setting mode

Hour setting mode

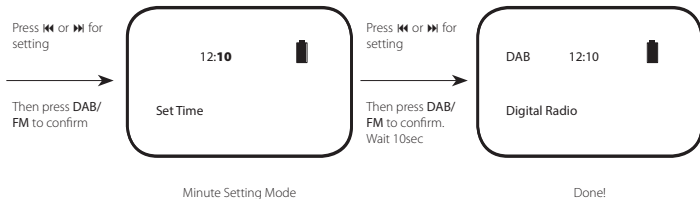

Minute Setting Mode

Done!

## Key Lock

**To enable key-lock:** Press and hold the **Volume -** button for 2 seconds, the word "LOCKED" will scroll on the OLED screen.



**To disable key-lock:** Press and hold the **Volume -** button for 2 seconds, the word "UNLOCK" will scroll on the OLED screen.



## DAB Radio Operation

### Auto Scan

For the first time, when you switch on the radio, the OLED screen will display the words "DAB Loading"; it will **automatically scan** for local DAB radio stations, then it will show "DAB Scanning..."

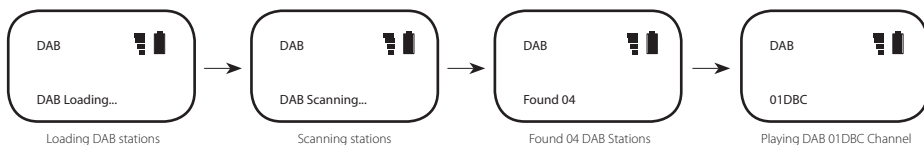

### Manual Scan

In DAB radio mode press and hold the DAB/FM for **2 seconds**, to enter "Store Mode", press **◀** or **▶** and choose "Rescan" and press DAB/FM to confirm", it will then show "DAB Scanning..." When scanning is completed, the OLED screen will display the number of the available DAB radio stations (eg. "FOUND: 04"). After that, it will play the last available DAB radio station. If no stations are found, the words "NO Signal" will appear on the OLED screen.

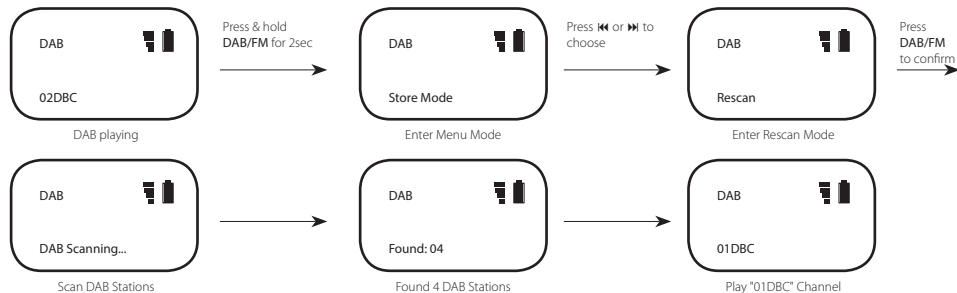

When it is completed, the OLED screen will display the number of the available DAB radio stations (eg. "FOUND: 04"). After 5 seconds, it will play the last available radio station. If no stations are found, the words "NO SIGNAL" will appear on the OLED screen.

### Listen to the DAB radio

When the scanning is completed, DAB-Clip radio will play the last available DAB radio station through searching. Press the **◀** button to choose the previous station or press the **▶** button to choose the next station. The name of the DAB radio station will appear on the OLED screen, (eg. "01DBC")

### Save your favourite list of the DAB radio stations

If you listen to certain stations regularly, you can save these as your favourite stations. There are 10 favourite stations that you can save. In DAB radio mode, press the **◀** or **▶** button to choose the station that you want to save, press and hold the DAB/FM button for 2 seconds, the words "Store Mode" will appear on the OLED screen, then press DAB/FM button once to select the stored position and OLED will show "Store TO FX?" (X is a number, from 0 to 9), then press **◀** or **▶** to select the favourite list (F0-F9), after that press the DAB/FM button once to complete the saving, the word "Stored" will appear on the OLED screen. Repeat these steps to save other favourites

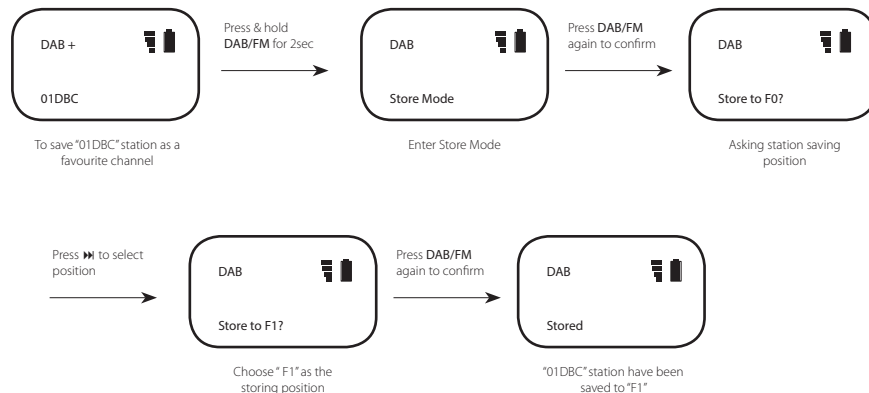

### Play the favourite DAB -radiostation

To select favourite mode, in DAB radio mode, press and hold the "DAB/FM" button for 2 seconds to enter then menu option, then press the ◀ or ▶ to enter the "Favourite mode", press again DAB/FM once to confirm the favourite mode, press the ◀ or ▶ button to choose the favourite station. OLED will show "FX Empty" if cannot save any station (x = 0~9). If accidentally enter the menu again, press the ◀ or ▶ button to choose "Exit" to exit.

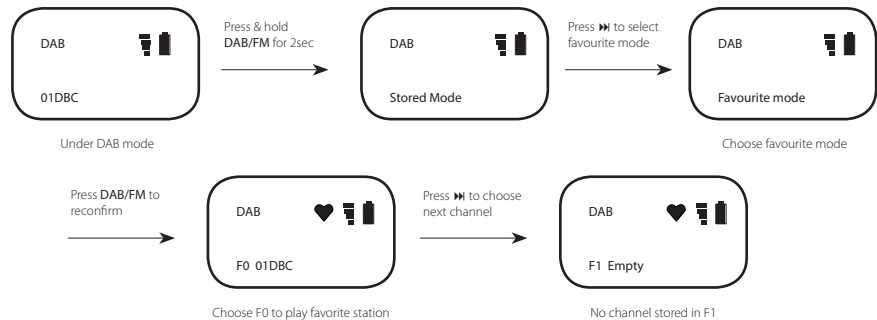

### Exit the favourite mode

In Favourite mode, press and hold the "DAB/FM" button for 2 seconds, OLED will display "Normal Mode"; press "DAB/FM" once again to confirm exiting Favourite Mode

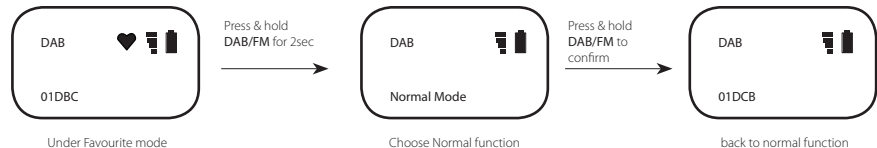

### Pause or play the Clip Radio

In DAB radio mode, press the ON/OFF button to pause the radio. Then, the clock will appear on the OLED screen. It will be adjusted by the DAB radio station automatically. To resume the radio, press the ON/OFF button again.

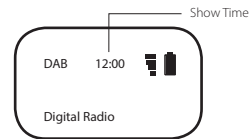

### Read Scrolling messages from DAB Station

While play DAB channel, if there are some messages from local stations, OLED will show the message, and DAB station name will be shown on the first line.

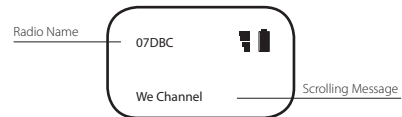



## FM RADIO Operation

### Listen to FM radio

In DAB mode, press the DAB/FM button once to change to FM mode. The OLED will show "FM Loading..." then The FM radio frequency will appear on the OLED screen such as M0 88.0MHz.

Press ◀ for previous channel and press ▶ for the next channel.

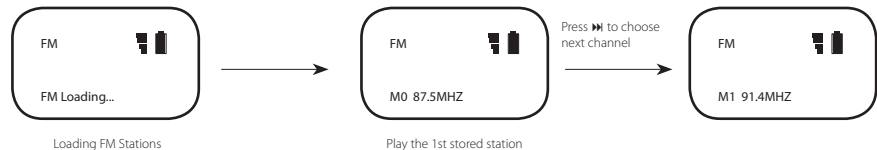

### Scan FM radio station

In FM radio mode, press and hold ◀ button for 2 seconds to scan the previous strongest signal FM station, press and hold ▶ for 2 seconds to scan the next strongest signal FM station. The OLED will show "FM Scanning...", it will store to the current position after scan.

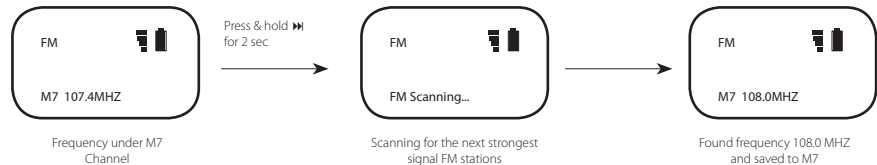

### Manual tuning

In FM radio mode, press and hold the DAB/FM button for 2 seconds until "Manual Tune" is shown on the OLED screen, the "FM TUNE" will be shown on the first line, press the ◀ and ▶ buttons to adjust the radio frequency, to finish manual tuning, press DAB/FM once to confirm.

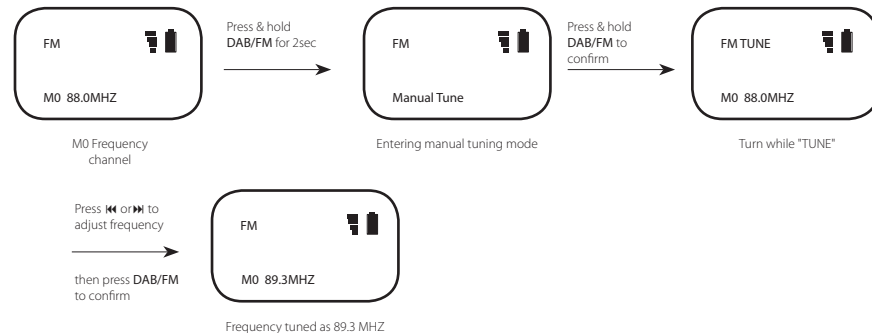

### Pause or Play FM-radio

In FM radio mode, press the ON/OFF button once to pause the radio. Then, the time clock will appear on the OLED screen. To resume the radio, press the ON/OFF button again.

## Power Off Timer

For power saving, users can set auto-power off by setting time, to avoid forgetting to turn power-off.

### Power off timer

While listening to the radio, to activate the power off timer function, press On/Off button once to enter the idle mode, then press and hold DAB/FM button to enter setting menu, choose "Auto Power Off" by pressing DAB/FM once, then press ◀ or ▶ buttons and choose "ON"; then press DAB/FM to confirm this power off time function, OLED will show "00:00"; then press ◀ or ▶ buttons to tune the time you would like to have auto power off, confirm by pressing DAB/FM once again

### \*\*Notice:

Clock icon "🕒" will show while this Power Off Timer function is activated. Once it has been activated, the function will keep looping as daily cycle depending on the set time, unless the Power Off Timer has been deactivated

### Turn on and Set Power Off Timer:

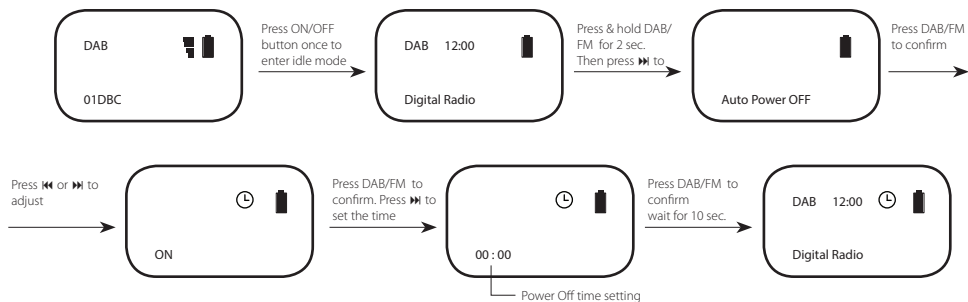

### Deactivate Power Off Timer

Under the idle mode, press and hold DAB/FM button to enter setting menu, choose "Auto Power Off" by pressing DAB/FM once, then press ◀ or ▶ and choose "OFF" to turn the function off, confirm by pressing DAB/FM once again to exit.

### \*\*Notice:

Clock icon "🕒" will disappear while this function is off and the power off looping function will be off.

### Turn off the Power Off Timer Function:

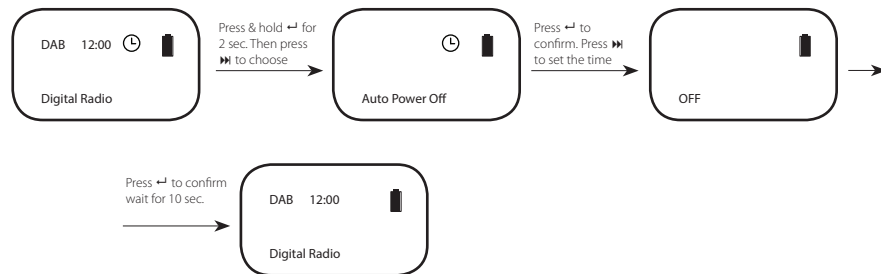

## Reset the DAB radio stations

When the Clip Radio is switched off, press and hold the DAB/FM button and the ON/OFF button at the same time for about 10 seconds to delete all the previously saved radio stations. When you switch on the radio again, it will automatically re-scan the new radio stations available.

## Safety Information

- 1) Do not listen at extremely high volumes. Doing so can damage your hearing.
- 2) Do not expose the radio to extremely high or low temperature.
- 3) Do not dispose the radio in a fire as it will result in an explosion.
- 4) Do not expose the radio to liquids, moisture or humidity as it is not waterproof.
- 5) Keep the radio away from sharp objects which will cause scratches and damages.
- 6) Do not attempt to take apart the radio as it does not contain replaceable components.
- 7) Do not store the radio in excessively dry, extremely temperature and dusty.

## Product specifications

- Multi-Language's Support (English, German, French, Italian, Norwegian, Danish, Swedish, Spanish)
- Build-in Polymer-Li rechargeable battery (Charging time: 4 hours)
- \*8 hours DAB Radio playing time
- 22 hours FM Radio playing time
- 3.5mm plug in headset socket
- Frequency range: (Band III): 174 ~240 MHz
- Frequency range: (FM): 87.5~108.0 MHz
- Memory for saving 60 DAB stations
- Memory for saving 10FM radio stations.
- Dimension: 48 X 35 X 15 mm.
- Weight: 30 grams.

\* May vary with signal strength

**\*Manuals in other languages - please check [www.oxxdigital.com](http://www.oxxdigital.com)**